



MEN

Attends Men are a range of protective shields and pads specially designed for the male anatomy for a close and comfortable fit. They are designed to manage very light to moderate bladder weakness, and they are available in different shapes.



Fitting Guide

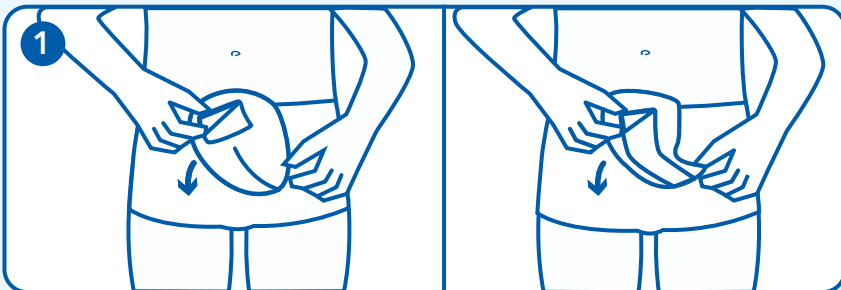

Remove the adhesive tape on the back of the product. Ensure the product is folded outwards, with the wider section (if any) facing upwards (as shown on the adhesive strip).

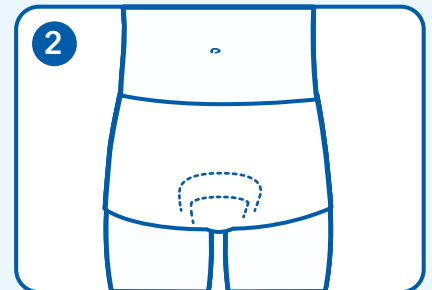

Place the product securely in close-fitting underwear (loose boxer shorts are not recommended).

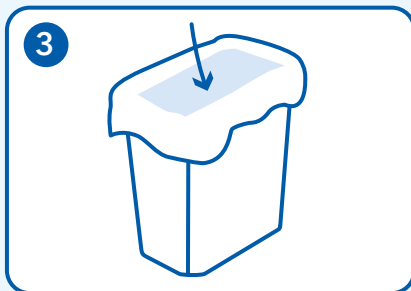

After use, roll up the used product and dispose of it in general waste.

MEN

Hints and Tips

Selection

- Select the required absorbency level.
- Choosing a lower absorbency level helps to reduce waste.
- For optimal performance, use the products in combination with close-fitting underwear (not boxer shorts).

Disposal

- Roll the products up and dispose of as per your local authority or NHS waste policy.
- You may use the single wrap, if provided, to dispose of the product.
- Do not flush the pad down the toilet.



Skin tolerability is dermatologically approved by SGS proderm Institute for Applied Dermatological Research.



STANDARD 100
SE 21-260
RISE
www.oeko-tex.com

With this label Attends For Men 1 and 2, Attends Men 2 and 3 are certified as being harmless for human health.